



7 Doncaster Road

Braithwell, Rotherham, S66 7BB

Asking Price £420,000



5



3



3



3



C

7 Doncaster Road



Description

Located within this ever popular rural village, a superbly well proportioned, individually designed detached family home, providing extensive family accommodation amounting to over 2,200 sq ft. This well presented property briefly comprises of, to the ground floor; 3 reception rooms, generous open plan kitchen / diner, with built in appliances. WC and utility room. 1st floor; bedroom suite with en suite shower room, 3 further bedrooms and family bathroom with separate shower. 2nd floor provides large master suite with en suite bathroom. Outside; private rear patio and seating areas, raised, low maintenance garden. To the front is plenty of off road parking and detached garage.

- large, architect designed family home in sought after village setting
- close to open countryside and attractive rural walks
- large rear open plan dining kitchen
- detached garage and further off road parking
- private patio and low maintenance gardens
- 3 reception rooms, WC and utility room
- easy access to local towns and motorway network
- a fine family home, well worthy of inspection





Floor Plan

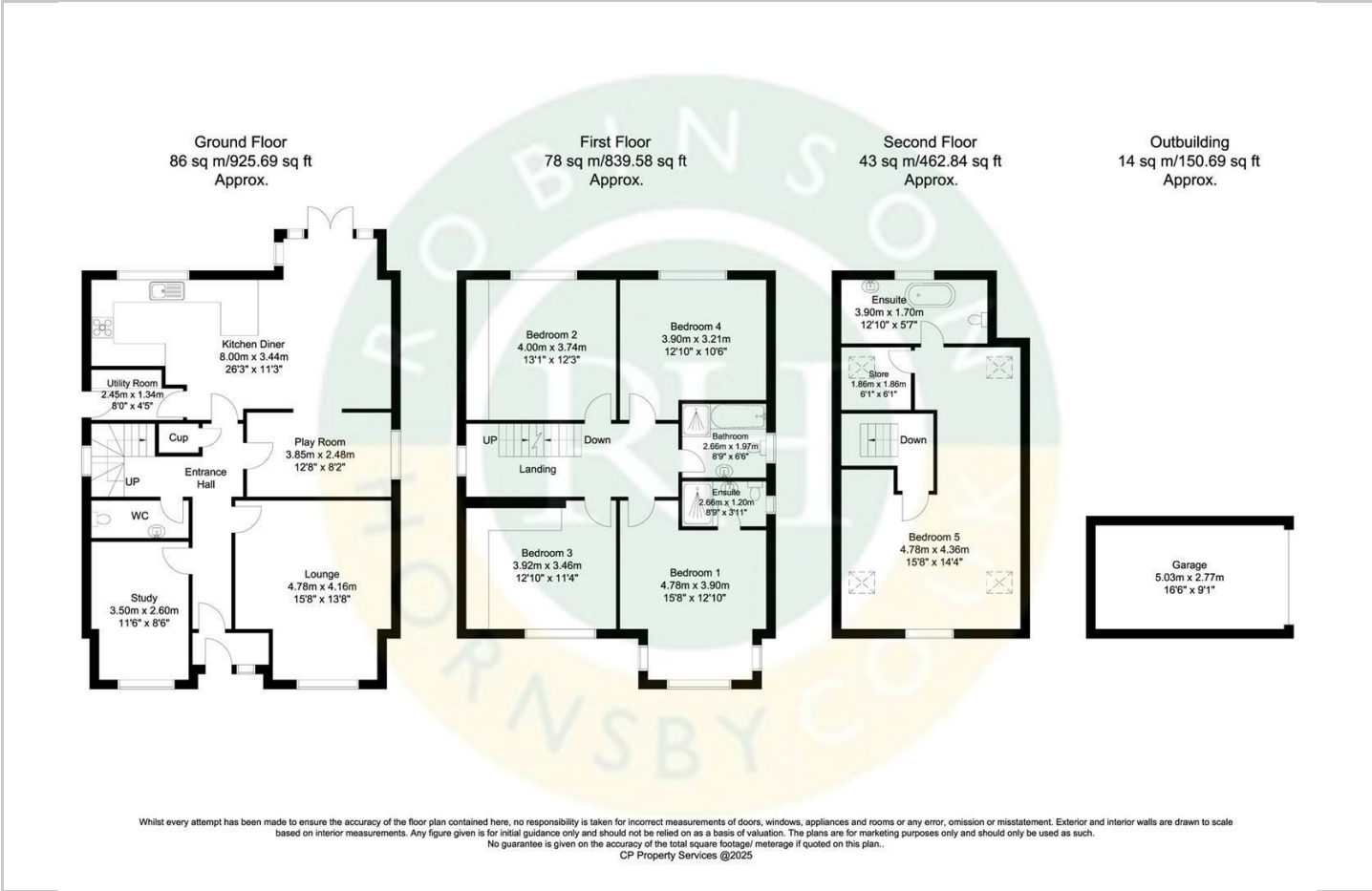

Area Map

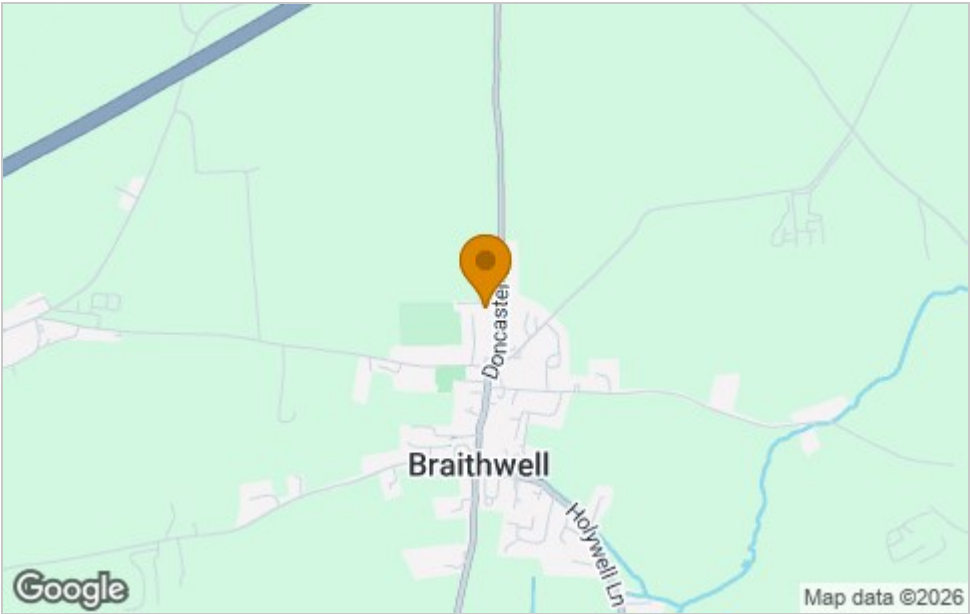

Energy Efficiency Graph

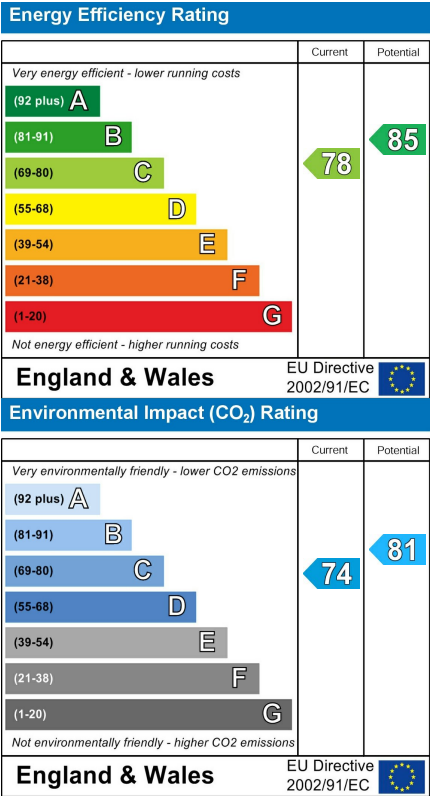

Viewing

Please contact our ELR Wickersley Office on 01709 917676 if you wish to arrange a viewing appointment for this property or require further information.

These particulars, whilst believed to be accurate are set out as a general outline only for guidance and do not constitute any part of an offer or contract. Intending purchasers should not rely on them as statements of representation of fact, but must satisfy themselves by inspection or otherwise as to their accuracy. No person in this firms employment has the authority to make or give any representation or warranty in respect of the property.